

Equalizer Family

“Exceeds the performance of similar and larger solenoids.”

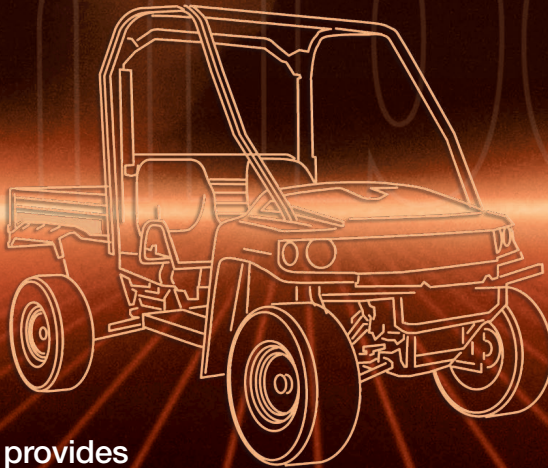

The Equalizer is decidedly unequal – it exceeds the performance of similar and larger solenoids. It provides greater operational capacity with no increase in solenoid size and does not require a separate control module and interconnect wiring. The result is consistent performance despite high temperatures and low voltage to the coil.

Applications that benefit from the Equalizer’s capabilities are differential locking devices for 4 wheel drive vehicles, utility vehicles and emergency shutdowns for enclosed, fuel-laden air supply conditions such as in mines or on oil rigs. Despite difficult conditions, the Equalizer can be used to cut off the air supply and eliminate combustible situations. For performance and peace of mind, the Equalizer provides unparalleled performance.

TROMBETTA 
DC Power Solutions for a Harsh World

Equalizer Family

Series	Max Stroke	Max Pull ¹ Force	Hold Force ²	Pull Current (Pulse)	Hold Current (Sustained)	Max Duty Cycle
ISE610	1"	12 lb	25 lbs	<50 amps average during pull-in	<1.0 amp average	10 cycles in 1 min. non-repetitive burst, 4 cycles/min sustained

¹–400C to 1050C and 10-15 VDC, ²–400C to 1050C and 6-15 VDC

Series	Operating VOLTAGE VDC Continuous	Operating Voltage VDC Intermittent (30 min.)	Operating Voltage VDC Jump Start (5 min. max)	Cycle Life	Recommended FUSE
ISE610	6.0V – 15.0V	16V	24V	100,000	MDL – 10 Fuse

Electrical Connection 3 pin Packard Electric Metri-Pack series 150 Male receptacle integral to solenoid. Also available with wire leads.

Mounting/Mechanical Interface Saddle type side mounting bracket with (2) 0.281 diameter holes on 2.00 inch centers. Flange mount with (2) 0.281 diameter holes on 2.50 inch centers

Related & other Performance Details 3rd electrical terminal provides low current control signal input. This feature allows the primary power wiring to be routed by most direct means to battery source. Light gauge control wiring may be run to point of command.

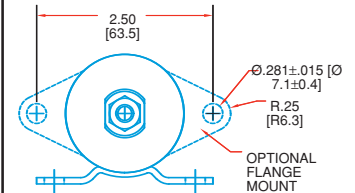
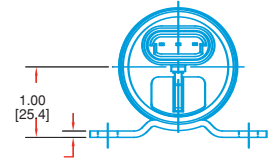

How Voltage & Temperature Affect the Equalizer vs. Dual Coil Solenoid with Coil Timer

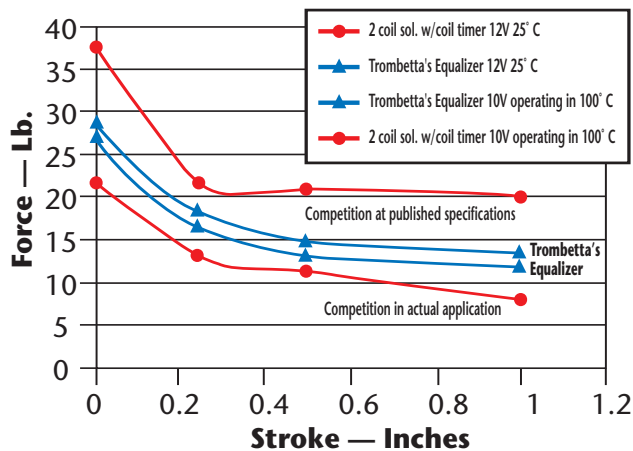

In the above chart, the most important specification is performance in actual application.

Trombetta's specifications in an actual application exceeds the competition's.

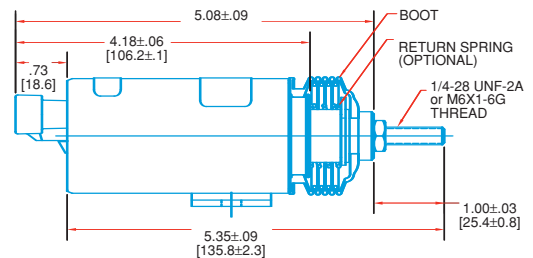

Solenoid Shown Energized

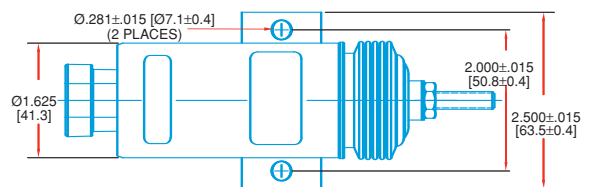

DIMENSIONS IN BRACKETS [] ARE METRIC

Note: It is required that dielectric grease be applied to each of the mating terminals of the Packard connector at installation. Appropriate grease would be Nyogel 760G or equivalent.

Reverse polarity of the solenoid must be avoided. Momentary application of reverse polarity may damage the internal controller.

TROMBETTA
DC Power Solutions for a Harsh World

Rev 5/16

8111 N. 87th Street, Milwaukee, WI 53224
P: 414-410-0300 • F: 414-355-3882 • e-mail: sales@trombetta.com

trombetta.com